

F11 - FORSTAL PADDLE

Ref. 3001 - 3002 - 3003 - 3004 - 3005 - 3006 - 3007 - 3008 - 3009 - 3021 - 3022 - 3023 - 3024 - 3025 - 3026 - 3027

Ship.	Code	Designation
J+5	1090705	10 X NUTS 3/4 GZ F11
J+5	1090707	10 X BRASS LOCK NUTS F11
J+5	1090712	10 X NYLON WASHERS F11
J+5	1090715	VERY LOW PRESSURE VALVE "0" F11
J+5	1090738	10 X STAINLESS STEEL PINS
J+1	1090757	10 X PLASTIC FILTERS
D	1090855	DEFLECTOR F 9 S (X5) BLISTER PACK
D	1090856	VALVE "S" F 9 S (X5) BLISTER PACK
D	1090858	SPRING F 11/FORSTAL (X5) BLISTER PACK
D	1090859	VALVE "H" F 9 S (X5) BLISTER PACK
D	1090877	COMPLETE VALVE "S" F 9 S BLISTER PACK
D	1090926	3 PLUG/WASHERS 1/2" FOR F11 BLISTER PACK
D	1090927	3 PLUG/WASHERS 3/4" BLISTER PACK
D	1090945	5 X NYLON WASHERS 24X18 F11 (BLISTER)
D	1090946	3 X VALVE SEATS F11 (BLISTER)
D	1090951	1 PLASTIC PADDLE F11-BLISTER
D	1090952	VERTICAL PLASTIC PADDLE F11-BLISTER
D	1090977	BLISTER WITH 1 BENT BODY 3/4 F11/FORSTAL WITH PADDLE
D	1090978	BLISTER WITH 1 T-CONNECTION 3/4 F11/FORSTAL PADDLE
J+5	1290115	STAINLESS STEEL PADDLE F11
J+5	4131528	F11 BOWL F11
J+5	4131531	BOWL FOR FORSTAL WITH PADDLE
J+5	4180414	BENT BODY 3/4 NPT
J+5	4650204	COMPLETE VALVE N.B-ST.STELL PADDLE
J+5	4650205	COMPLETE VALVE "0" - ST.STEEL PADDLE F11
J+1	4680102	PADDLE STOP

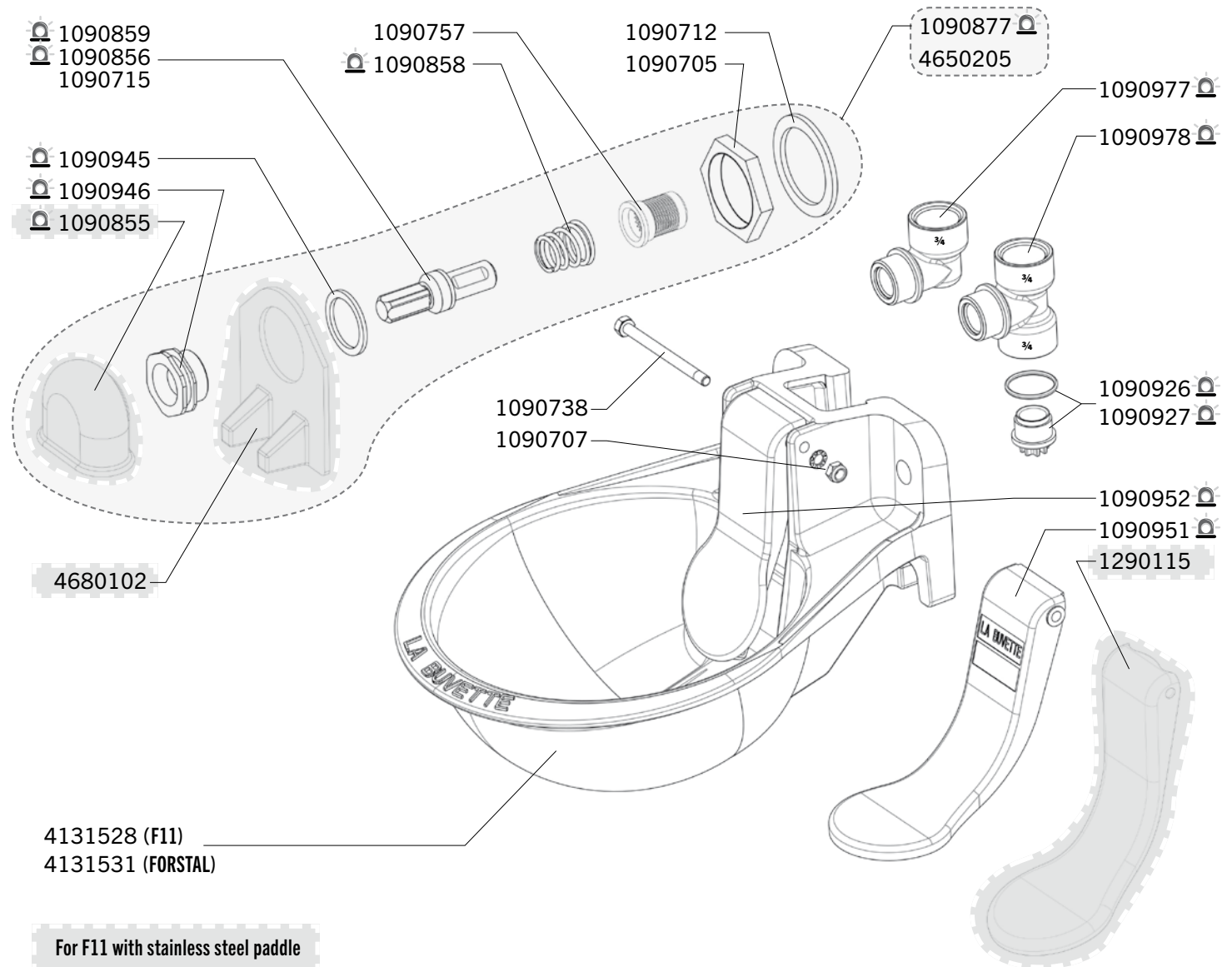

For F11 with stainless steel paddle

Shipping time in working days (running out of stock excepted), spare parts tagged with a are dispatched the same day if order received before noon and made of parts tagged with (J) exclusively.